

GREENCREATIVE

Bringing You the Latest in LED Technology



2015 FALL PRODUCT CATALOG



GREENCREATIVE

GREEN CREATIVE is a 5-year-old solid state lighting development and manufacturing company based in Silicon Valley, CA. The company offers a comprehensive line of high-performance LED lighting solutions which has been widely adopted by some of the largest companies in the world.

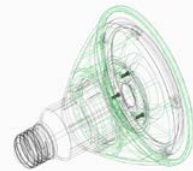

Bringing you the latest in LED technology

Anchored by strong integrated R&D capabilities, GREEN CREATIVE innovation, performance and reliability have been recognized year after year by the Illuminating Engineering Society Progress Report, the LEDs Magazine Sapphire Awards and Lighting For Tomorrow.

A complete line with national & international distribution

GREEN CREATIVE's full product line of ENERGY STAR, DLC and CEC certified indoor retrofit and new construction lighting solutions serves the Retail, Hospitality, Food & Beverage, Office and Education industries through multiple distribution centers and sales networks across the USA.



FALL 2015 FEATURED PRODUCTS

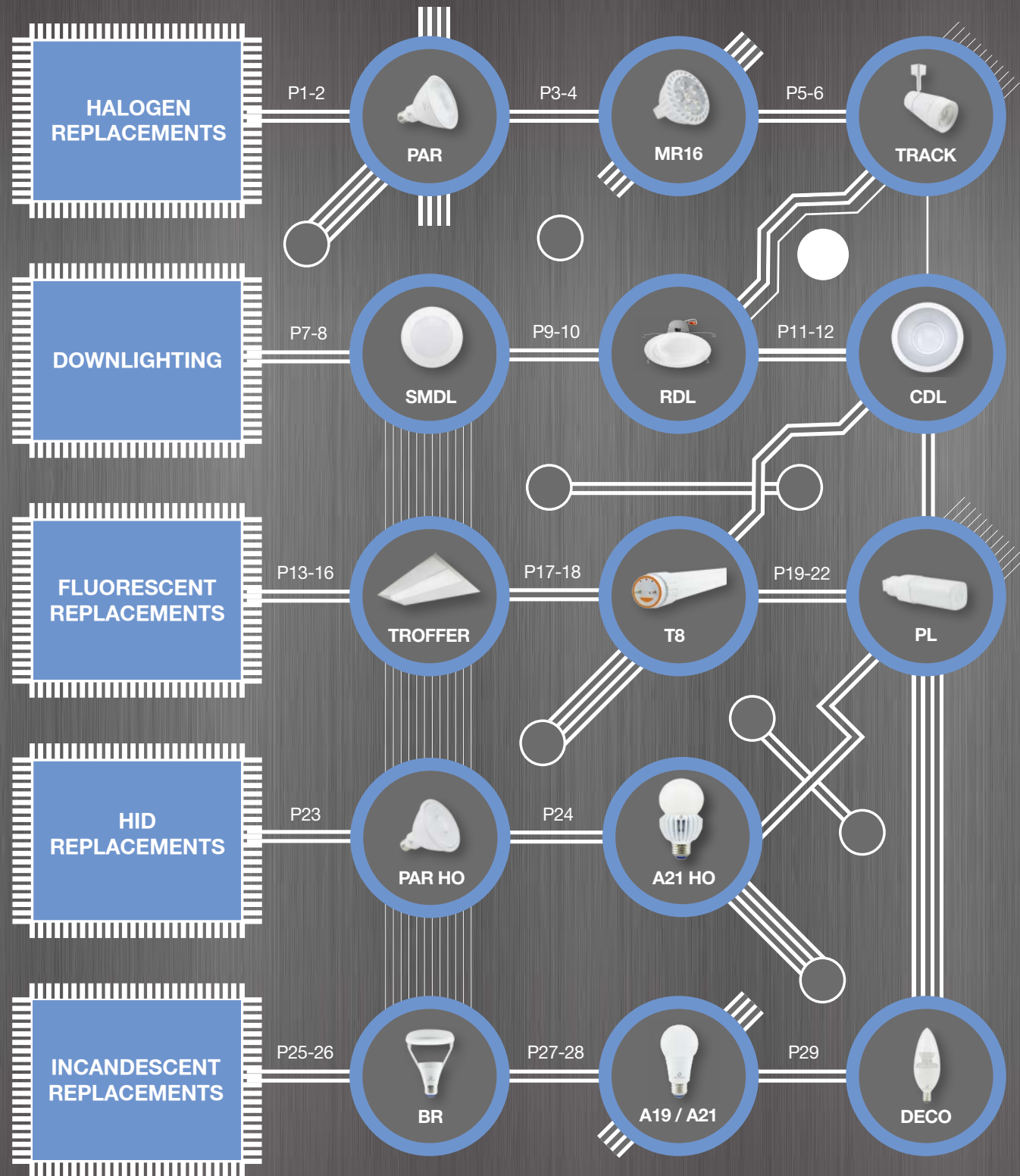

DL 6" & 4"

Wet location & CRI 90 versions
High output 1150 lumen version
Fits 5-6" housing (DL 6")



COMMERCIAL DOWNLIGHT

6", 8" & 9.5" versions
Universal voltage 120-277V
0-10V dimming



TROFFER 2X4' & 2X2'

110 LPW efficacy
Universal voltage 120-277V
Architectural finish



TROFFER RETROFIT KIT 2X4' & 2X2'

115 LPW efficacy
Universal voltage 120-277V
Easily upgrade existing fixture



PLL DIR

Electronic ballast compatible
Enclosed fixture rated
Replaces 36W & 40W Biac



PLS HYB & BYP

GX23 & G23 HYBRid versions
GX27 & G27 BYPass versions
Replaces 7, 9 & 13W CFL



PAR38 HO 277V

10,000+ candela
Universal voltage 120-277V
Replaces 250W Hal & 39W CMH



A21 HO 277V

Bollard & post top applications
Replaces 50-70W HID
Enclosed fixture rated



B11 CANDLE

60W equivalent
Unique crown lens
Omnidirectional light output



Patent Pending REFINE Optic



WATCH THE VIDEO

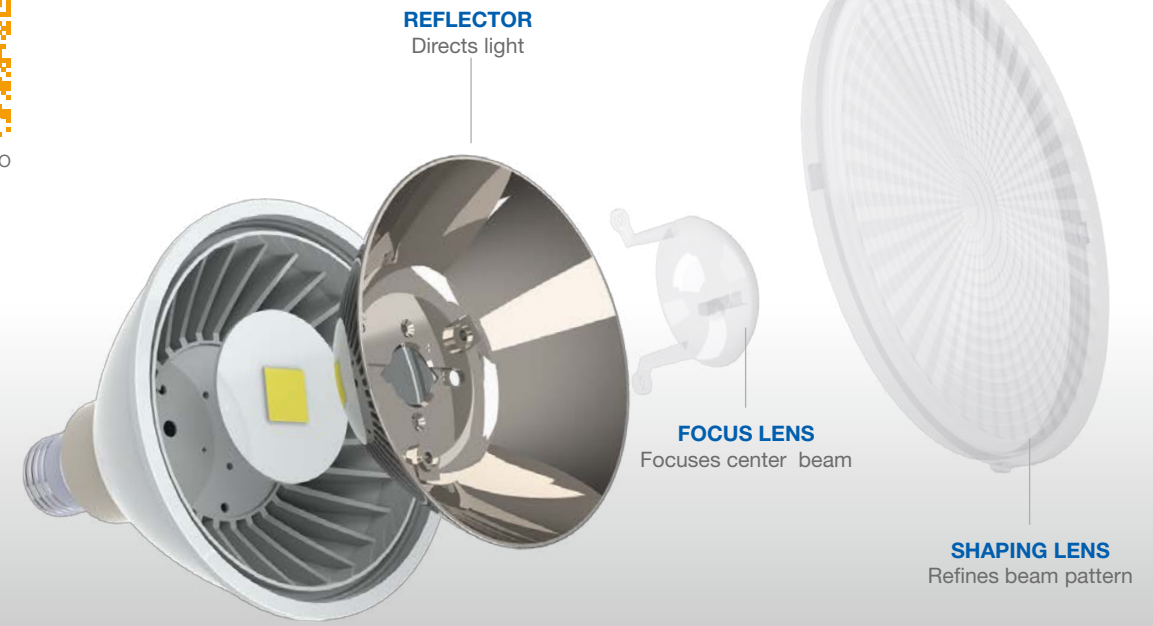

SPECIFICATIONS

Model	Product	CCT	Lumens (lm)	Equiv.	LPW	Beam Angle	CBCP (cd)	CRI (typ.)	Dim	Life (hrs)	Voltage	Encl.	Energy Star	
PAR38 17W	18.5PAR38G4DIM/927SP15	16147	2700K	950	100W	51	15°	10,500	90	Yes	40,000	120V	Yes	✓
	18.5PAR38G4DIM/927NF25	16148	2700K	950	120W	51	25°	5390	90	Yes	40,000	120V	Yes	✓
	17PAR38G4DIM/927FL40	16149	2700K	1105	120W	65	40°	2400	90	Yes	40,000	120V	Yes	✓
	18.5PAR38G4DIM/930SP15	16150	3000K	1000	100W	54	15°	11,000	90	Yes	40,000	120V	Yes	✓
	18.5PAR38G4DIM/930NF25	16151	3000K	1000	120W	54	25°	5400	90	Yes	40,000	120V	Yes	✓
	17PAR38G4DIM/930FL40	16152	3000K	1150	120W	68	40°	2500	90	Yes	40,000	120V	Yes	✓
	17PAR38G4DIM/940FL40	16155	4000K	1200	120W	71	40°	2650	90	Yes	40,000	120V	Yes	✓
	18.5PAR38G4DIM/930SP15/B •	16256	3000K	1000	100W	54	15°	11,000	90	Yes	40,000	120V	Yes	✓
	18.5PAR38G4DIM/930NF25/B •	16257	3000K	1000	120W	54	25°	5400	90	Yes	40,000	120V	Yes	✓
17PAR38G4DIM/930FL40/B •	16258	3000K	1150	120W	68	40°	2500	90	Yes	40,000	120V	Yes	✓	
PAR38 17W 277V	17PAR38G4/930FL40/277V	16161	3000K	1150	120W	68	40°	2500	90	No	40,000	120-277V	Yes	✓
	17PAR38G4/940FL40/277V	16164	4000K	1200	120W	71	40°	2650	90	No	40,000	120-277V	Yes	✓
PAR38 17W GU24	17PAR38G4DIM/927FL40/GU24	16303	2700K	1105	120W	65	40°	2400	90	Yes	40,000	120V	Yes	✓
	17PAR38G4DIM/930FL40/GU24	16306	3000K	1150	120W	68	40°	2500	90	Yes	40,000	120V	Yes	✓
PAR30 12.5W	14.5PAR30G4DIM/927SP15	16111	2700K	725	75W	50	15°	6155	90	Yes	40,000	120V	Yes	✓
	12.5PAR30G4DIM/927NF25	16112	2700K	815	75W	65	25°	3350	90	Yes	40,000	120V	Yes	✓
	12.5PAR30G4DIM/927FL40	16113	2700K	815	75W	65	40°	1750	90	Yes	40,000	120V	Yes	✓
	14.5 PAR30G4DIM/930SP15	16114	3000K	760	75W	52	15°	6250	90	Yes	40,000	120V	Yes	✓
	12.5PAR30G4DIM/930NF25	16115	3000K	850	75W	68	25°	3600	90	Yes	40,000	120V	Yes	✓
	12.5PAR30G4DIM/930FL40	16116	3000K	850	75W	68	40°	1850	90	Yes	40,000	120V	Yes	✓
	12.5PAR30G4DIM/940FL40	16119	4000K	900	75W	72	40°	2050	90	Yes	40,000	120V	Yes	✓
	14.5PAR30G4DIM/930SP15/B •	16208	3000K	760	75W	52	15°	6250	90	Yes	40,000	120V	Yes	✓
	12.5PAR30G4DIM/930NF25/B •	16209	3000K	850	75W	68	25°	3600	90	Yes	40,000	120V	Yes	✓
	12.5PAR30G4DIM/930FL40/B •	16210	3000K	850	75W	68	40°	1850	90	Yes	40,000	120V	Yes	✓

* PAR38 models are suitable for use in wet locations
• Black finish

SPECIFICATIONS

Model	Product	CCT	Lumens (lm)	Equiv.	LPW	Beam Angle	CBCP (cd)	CRI (typ.)	Dim	Life (hrs)	Voltage	Encl.	Energy Star	
PAR30 12.5W 277V	12.5PAR30G4/930FL40/277V	16125	3000K	850	75W	68	40°	1850	90	No	40,000	120-277V	Yes	✓
	12.5PAR30G4/940FL40/277V	16128	4000K	900	75W	72	40°	2050	90	No	40,000	120-277V	Yes	✓
PAR30 12.5W GU24	12.5PAR30G4DIM/927FL40/GU24	16279	2700K	815	75W	65	40°	1750	90	Yes	40,000	120V	Yes	✓
	12.5PAR30G4DIM/930FL40/GU24	16282	3000K	850	75W	68	40°	1850	90	Yes	40,000	120V	Yes	✓
PAR30SN 11W	14PAR30SNG4DIM/927SP15	16129	2700K	700	75W	50	15°	6155	90	Yes	40,000	120V	Yes	✓
	11PAR30SNG4DIM/927NF25	16130	2700K	705	75W	64	25°	2910	90	Yes	40,000	120V	Yes	✓
	11PAR30SNG4DIM/927FL40	16131	2700K	705	75W	64	40°	1400	90	Yes	40,000	120V	Yes	✓
	14PAR30SNG4DIM/930SP15	16132	3000K	725	75W	52	15°	6200	90	Yes	40,000	120V	Yes	✓
	11PAR30SNG4DIM/930NF25	16133	3000K	740	75W	67	25°	2910	90	Yes	40,000	120V	Yes	✓
	11PAR30SNG4DIM/930FL40	16134	3000K	740	75W	67	40°	1450	90	Yes	40,000	120V	Yes	✓
	11PAR30SNG4DIM/940FL40	16137	4000K	780	75W	71	40°	1500	90	Yes	40,000	120V	Yes	✓
	14PAR30SNG4DIM/930SP15/B •	16232	3000K	725	75W	52	15°	6200	90	Yes	40,000	120V	Yes	✓
11PAR30SNG4DIM/930NF25/B •	16233	3000K	740	75W	67	25°	2910	90	Yes	40,000	120V	Yes	✓	
11PAR30SNG4DIM/930FL40/B •	16234	3000K	740	75W	67	40°	1450	90	Yes	40,000	120V	Yes	✓	
PAR20 7W	7PAR20G4DIM/927FL40	16108	2700K	460	50W	66	40°	600	90	Yes	40,000	120V	Yes	✓
	7PAR20G4DIM/930FL40	16109	3000K	480	50W	69	40°	650	90	Yes	40,000	120V	Yes	✓
	7PAR20G4DIM/940FL40	16110	4000K	505	50W	72	40°	700	90	Yes	40,000	120V	Yes	✓
	7PAR20G4DIM/930FL40/B •	16202	3000K	480	50W	69	40°	650	90	Yes	40,000	120V	Yes	✓

• Black finish

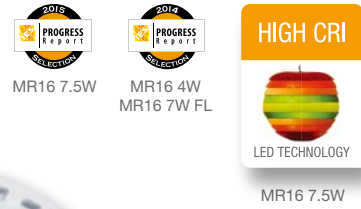

True 75W Halogen Replacement

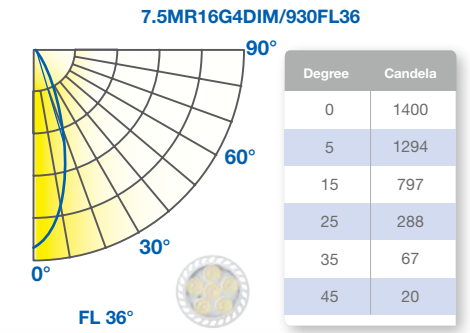
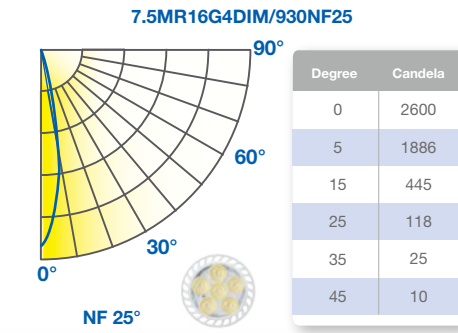
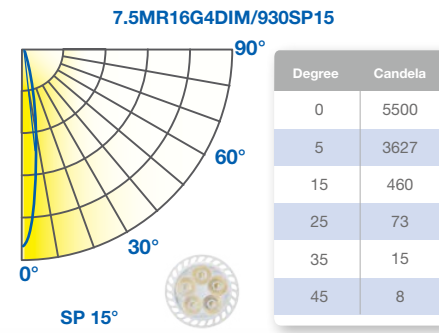

MR16 7.5W - High CRI

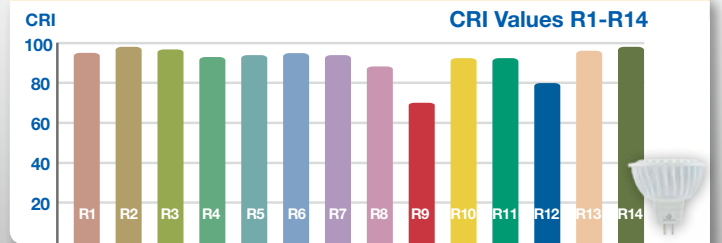

- Most efficient high CRI MR16 75W halogen replacement
- Exceptional color rendering CRI 92
- Richer reds and natural skin tones (R9 70, R13 96)
- Suitable for use in totally enclosed fixtures

SPECIFICATIONS

Model	Product	CCT	Lumens (lm)	Equiv.	LPW	Beam Angle	CBCP (cd)	CRI (typ.)	Dim	Life (hrs)	Voltage	Encl.	Energy Star	
MR16 7.5W	7.5MR16G4DIM/927SP15	40804	2700K	410	75W	55	15°	5500	92	Yes	25,000	12V	Yes	✓
	7.5MR16G4DIM/927NF25	40805	2700K	485	75W	63	25°	2600	92	Yes	25,000	12V	Yes	✓
	7.5MR16G4DIM/927FL36	40806	2700K	485	75W	63	36°	1400	92	Yes	25,000	12V	Yes	✓
	7.5MR16G4DIM/930SP15	40807	3000K	430	75W	57	15°	5500	92	Yes	25,000	12V	Yes	✓
	7.5MR16G4DIM/930NF25	40808	3000K	505	75W	66	25°	2600	92	Yes	25,000	12V	Yes	✓
	7.5MR16G4DIM/930FL36	40809	3000K	505	75W	66	36°	1400	92	Yes	25,000	12V	Yes	✓
	7.5MR16G4DIM/840SP15	40810	4000K	485	75W	65	15°	5700	82	Yes	25,000	12V	Yes	✓
	7.5MR16G4DIM/840NF25	40811	4000K	625	75W	81	25°	2800	82	Yes	25,000	12V	Yes	✓
7.5MR16G4DIM/840FL36	40812	4000K	625	75W	81	36°	1600	82	Yes	25,000	12V	Yes	✓	
MR16 7W	7MR16G3DIM/827NF25	95339	2700K	500	45W	71	25°	2325	80	Yes	25,000	12V	No	✓
	7MR16G3DIM/830NF25	95337	3000K	525	50W	75	25°	2350	80	Yes	25,000	12V	No	✓
	7MR16G3DIM/840NF25	95341	4000K	550	50W	79	25°	2400	80	Yes	25,000	12V	No	✓
MR16 7W	7MR16G4DIM/827FL36	40758	2700K	525	50W	75	36°	1255	80	Yes	25,000	12V	Yes	✓
	7MR16G4DIM/830FL36	40759	3000K	560	50W	80	36°	1265	80	Yes	25,000	12V	Yes	✓
	7MR16G4DIM/840FL36	40760	4000K	580	50W	83	36°	1285	80	Yes	25,000	12V	Yes	✓

SPECIFICATIONS

Model	Product	CCT	Lumens (lm)	Equiv.	LPW	Beam Angle	CBCP (cd)	CRI (typ.)	Dim	Life (hrs)	Voltage	Encl.	Energy Star	
MR16 6W	6MR16G4DIM/827FL36	40755	2700K	425	35W	71	36°	900	80	Yes	25,000	12V	Yes	✓
	6MR16G4DIM/830FL36	40756	3000K	450	35W	75	36°	925	80	Yes	25,000	12V	Yes	✓
MR16 4W	4MR16G4/827FL36	40721	2700K	270	20W	68	36°	635	80	No	25,000	12V	Yes	✓
	4MR16G4/830FL36	40720	3000K	270	20W	68	36°	635	80	No	25,000	12V	Yes	✓
GU10 6W	6GU10G4DIM/827FL36	40716	2700K	425	50W	71	36°	900	80	Yes	25,000	120V	Yes	✓
	6GU10G4DIM/830FL36	40717	3000K	450	50W	75	36°	925	80	Yes	25,000	120V	Yes	✓
PAR16 6W	6PAR16G4DIM/827FL36	40723	2700K	425	60W	71	36°	900	80	Yes	25,000	120V	Yes	✓
	6PAR16G4DIM/830FL36	40724	3000K	450	60W	75	36°	925	80	Yes	25,000	120V	Yes	✓
MR11 3W	3MR11G4/827NF30	40713	2700K	200	20W	67	30°	600	80	No	25,000	12V	Yes	N.A.
	3MR11G4/840NF30	40715	4000K	220	20W	73	30°	620	80	No	25,000	12V	Yes	N.A.

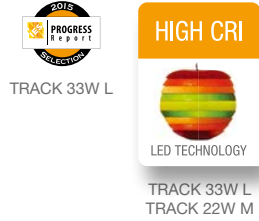

Interchangeable Lens Options (TRACK L & M)

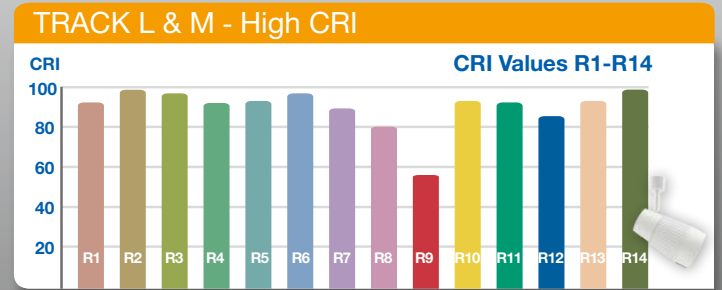
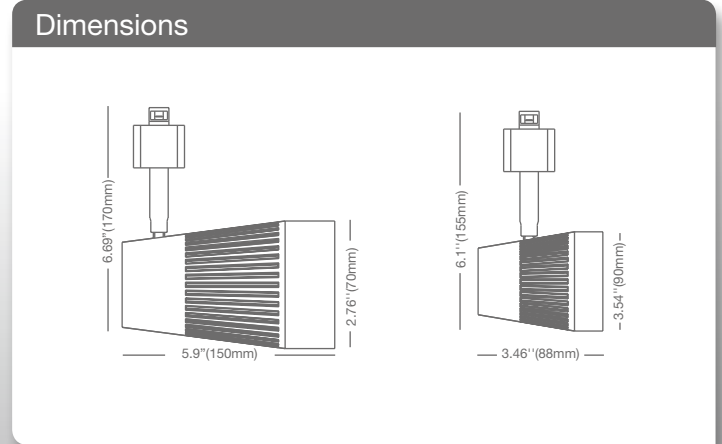
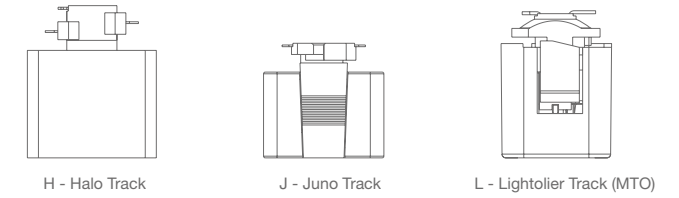

- Exceptional color rendering CRI 90
- Tight LED binning – 4-step Macadam ellipse
- Sleek design, integrated driver
- NF & FL optics ship with TRL & TRM versions

SPECIFICATIONS

Model	Product	CCT	Lumens (lm)	Equiv.	LPW	Beam Angle	CBCP (cd)	CRI (typ.)	Dim	Life (hrs)	Voltage	ENERGY STAR	
TRL 33W	NEW! 33TRLG4DIM/927/W/H	97623	2700K	2200	39W HID	65	25°/38°	10,000/5150	90	Yes	40,000	120V	✓
	33TRLG4DIM/930/W/H	97629	3000K	2300	39W HID	68	25°/38°	10,350/5250	90	Yes	40,000	120V	✓
	33TRLG4DIM/927/W/J	97624	2700K	2200	39W HID	65	25°/38°	10,000/5150	90	Yes	40,000	120V	✓
	33TRLG4DIM/930/W/J	97630	3000K	2300	39W HID	68	25°/38°	10,350/5250	90	Yes	40,000	120V	✓
	33TRLG4DIM/927/B/H •	97626	2700K	2200	39W HID	65	25°/38°	10,000/5150	90	Yes	40,000	120V	✓
	33TRLG4DIM/930/B/H •	97632	3000K	2300	39W HID	68	25°/38°	10,350/5250	90	Yes	40,000	120V	✓
	33TRLG4DIM/927/B/J •	97627	2700K	2200	39W HID	65	25°/38°	10,000/5150	90	Yes	40,000	120V	✓
33TRLG4DIM/930/B/J •	97633	3000K	2300	39W HID	68	25°/38°	10,350/5250	90	Yes	40,000	120V	✓	
TRM 22W	NEW! 22TRMG4DIM/927/W/H	97587	2700K	1200	20W HID	55	25°/38°/15°	6300/3250/12,200	90	Yes	40,000	120V	✓
	22TRMG4DIM/930/W/H	97599	3000K	1250	20W HID	57	25°/38°/15°	6700/3450/13,000	90	Yes	40,000	120V	✓
	22TRMG4DIM/927/W/J	97588	2700K	1200	20W HID	55	25°/38°/15°	6300/3250/12,200	90	Yes	40,000	120V	✓
	22TRMG4DIM/930/W/J	97600	3000K	1250	20W HID	57	25°/38°/15°	6700/3450/13,000	90	Yes	40,000	120V	✓
	22TRMG4DIM/927/B/H •	97590	2700K	1200	20W HID	55	25°/38°/15°	6300/3250/12,200	90	Yes	40,000	120V	✓
	22TRMG4DIM/930/B/H •	97602	3000K	1250	20W HID	57	25°/38°/15°	6700/3450/13,000	90	Yes	40,000	120V	✓
	22TRMG4DIM/927/B/J •	97591	2700K	1200	20W HID	55	25°/38°/15°	6300/3250/12,200	90	Yes	40,000	120V	✓
22TRMG4DIM/930/B/J •	97603	3000K	1250	20W HID	57	25°/38°/15°	6700/3450/13,000	90	Yes	40,000	120V	✓	

* The J and L type adaptors are compatible with single or two-circuit track types. The H type adaptor is only compatible with single-circuit track types
• Black finish

SPECIFICATIONS

Model	Product	CCT	Lumens (lm)	Equiv.	LPW	Beam Angle	CBCP (cd)	CRI (typ.)	Dim	Life (hrs)	Voltage	ENERGY STAR	
TRS 8W	NEW! 8TRSG4DIM/827NF30/W/H	16340	2700K	600	75W Hal	68	30°	1905	80	Yes	40,000	120V	✓
	8TRSG4DIM/830NF30/W/H	16346	3000K	625	75W Hal	71	30°	1950	80	Yes	40,000	120V	✓
	8TRSG4DIM/827NF30/W/J	16341	2700K	600	75W Hal	68	30°	1905	80	Yes	40,000	120V	✓
	8TRSG4DIM/830NF30/W/J	16347	3000K	625	75W Hal	71	30°	1950	80	Yes	40,000	120V	✓
	8TRSG4DIM/827NF30/B/H •	16343	2700K	600	75W Hal	68	30°	1905	80	Yes	40,000	120V	✓
	8TRSG4DIM/830NF30/B/H •	16349	3000K	625	75W Hal	71	30°	1950	80	Yes	40,000	120V	✓
	8TRSG4DIM/827NF30/B/J •	16344	2700K	600	75W Hal	68	30°	1905	80	Yes	40,000	120V	✓
	8TRSG4DIM/830NF30/B/J •	16350	3000K	625	75W Hal	71	30°	1950	80	Yes	40,000	120V	✓

* The J and L type adaptors are compatible with single or two-circuit track types. The H type adaptor is only compatible with single-circuit track types
• Black finish



Dual Installation & High CRI

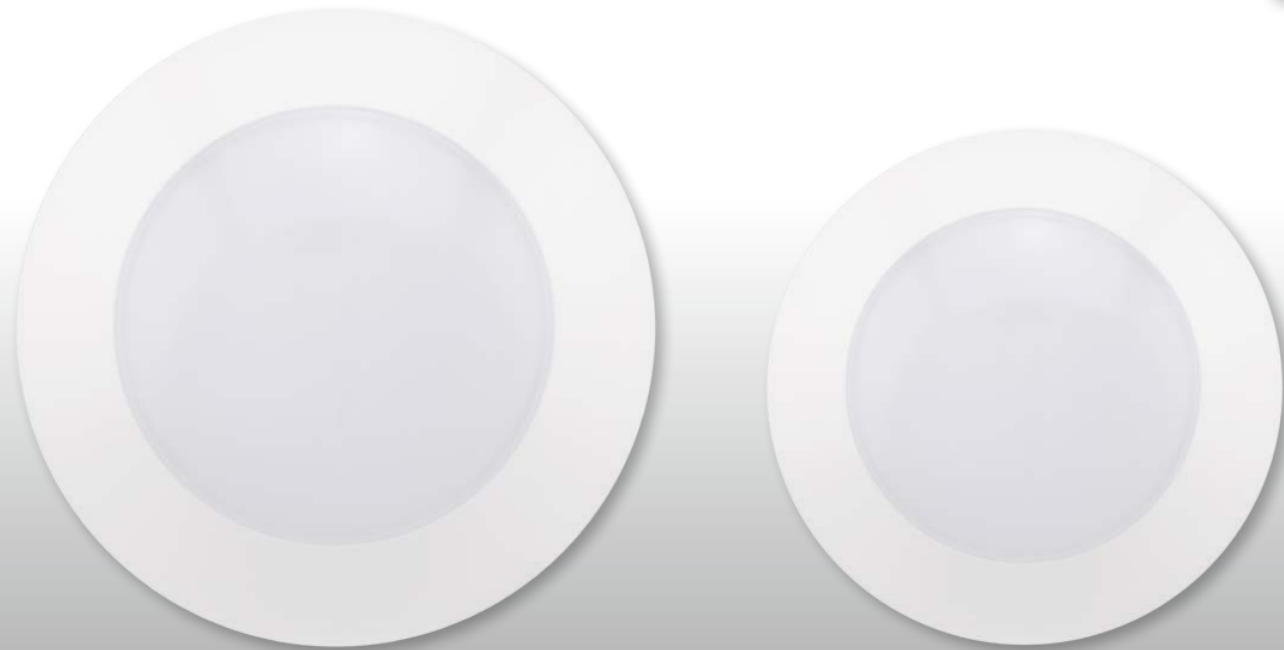

Accessories

- 6" Mounting Bracket
- 4" Mounting Bracket
- J-Box Screws
- 6" Mounting Springs
- 4" Mounting Clips
- LED Adapter
- E26 Adapter

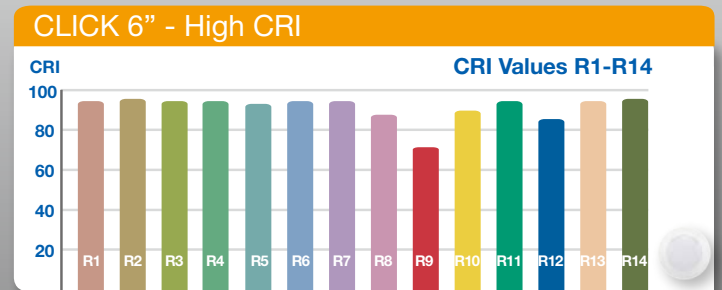

- Both versions compatible with 4" J-boxes
- Also compatible with 5-6" or 4" recessed cans
- Installs in just minutes - no rewiring
- GU24 connector available

SPECIFICATIONS

Model	Product	CCT	Lumens (lm)	Equiv.	LPW	Beam Angle	CBCP (cd)	CRI (typ.)	Dim	Life (hrs)	Voltage	Encl.	Energy Star	
SMDL 6" 14.5W	14.5SMDL6G4DIM/927	40842	2700K	950	75W	66	110°	N.A.	90	Yes	40,000	120V	No	✓
	14.5SMDL6G4DIM/930	40843	3000K	950	75W	66	110°	N.A.	90	Yes	40,000	120V	No	✓
	14.5SMDL6G4DIM/840	40847	4000K	1150	85W	79	110°	N.A.	80	Yes	40,000	120V	No	✓
SMDL 4" 10W	10SMDL4G4DIM/927	40833	2700K	600	50W	60	110°	N.A.	90	Yes	40,000	120V	No	✓
	10SMDL4G4DIM/930	40834	3000K	625	50W	63	110°	N.A.	90	Yes	40,000	120V	No	✓

* GU24 connector available

INSTALLATION GUIDE

CLICK 6"

4" J-BOX FLUSHMOUNT

- Attach mounting bracket to J-box
- Click downlight into mounting bracket

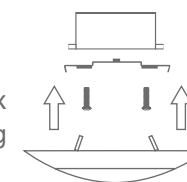

5-6" RECESSED CAN

- Connect E26 adapter to the LED adapter
- Squeeze mounting springs and push downlight up until flush with ceiling

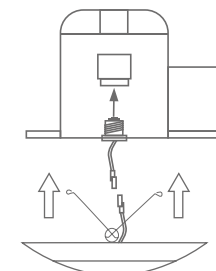

CLICK 4"

4" J-BOX FLUSHMOUNT

- Attach mounting bracket to J-box
- Click downlight into mounting bracket

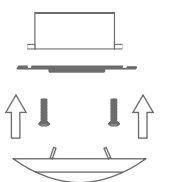

4" RECESSED CAN

- Connect E26 adapter to the LED adapter
- Insert mounting clips and push downlight up until flush with ceiling

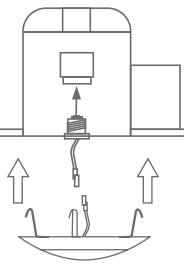



T24 2013

DL 6" 16W
DL 5-6" 12W
DL 4" 12W

CEC

DL 6" 16W
DL 5-6" 12W
DL 4" 12W

HIGH CRI



LED TECHNOLOGY
DL 6" 16W
DL 5-6" 12W
DL 4" 12W



Adjustable springs to fit 5-6" housings. High CRI versions rated for wet locations.

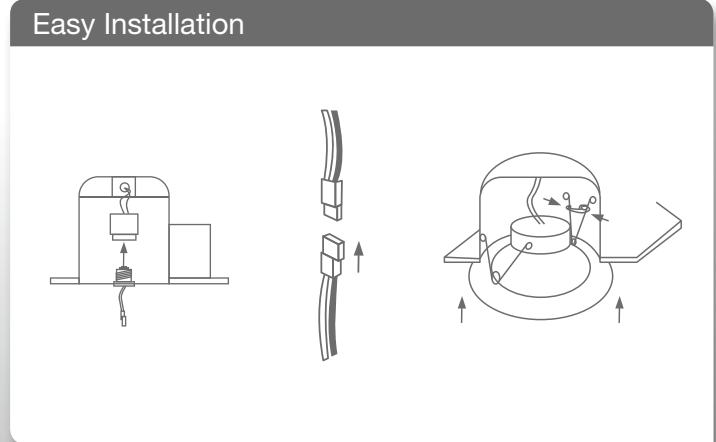

- Compatible with 5-6" and 4" housings
- Installs in just minutes – no rewiring
- High output 1150 lumen version
- High CRI versions rated for wet locations

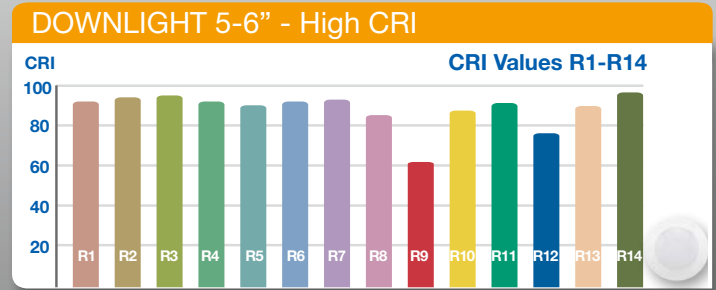

SPECIFICATIONS

Model	Product	CCT	Lumens (lm)	Equiv.	LPW	Beam Angle	CBCP (cd)	CRI (typ.)	Dim	Life (hrs)	Voltage	Wet	ENERGY STAR	
DL 5-6" 17.5W	17.5DL6DIM/830 NEW!	97760	3000K	1150	100W	65	100°	N.A.	80	Yes	35,000	120V	No	✓
	17.5DL6DIM/840	97761	4000K	1200	100W	68	100°	N.A.	80	Yes	35,000	120V	No	✓
DL 6" 16W	16DL6G3DIM/927	40710	2700K	800	75W	50	100°	N.A.	92	Yes	35,000	120V	No	✓
	16DL6G3DIM/930	40711	3000K	850	75W	53	100°	N.A.	92	Yes	35,000	120V	No	✓
DL 5-6" 12W	12DL6DIM/927 NEW!	97765	2700K	720	65W	60	100°	N.A.	90	Yes	35,000	120V	Yes	✓
	12DL6DIM/930	97766	3000K	750	65W	63	100°	N.A.	90	Yes	35,000	120V	Yes	✓
DL 6" 12W	12DL6G3DIM/827	40695	2700K	750	65W	63	100°	N.A.	82	Yes	35,000	120V	No	✓
DL 5-6" 10W	10DL6DIM/827 NEW!	97756	2700K	700	65W	65	100°	N.A.	80	Yes	35,000	120V	No	✓
	10DL6DIM/830	97757	3000K	700	65W	65	100°	N.A.	80	Yes	35,000	120V	No	✓

* GU24 connector available

SPECIFICATIONS

Model	Product	CCT	Lumens (lm)	Equiv.	LPW	Beam Angle	CBCP (cd)	CRI (typ.)	Dim	Life (hrs)	Voltage	Wet	ENERGY STAR	
DL 4" 12W	12DL4DIM/927 NEW!	97762	2700K	600	50W	50	85°	N.A.	90	Yes	35,000	120V	Yes	✓
	12DL4DIM/930	97763	3000K	650	50W	54	85°	N.A.	90	Yes	35,000	120V	Yes	✓
DL 4" 12W	12DL4G3DIM/927	40712	2700K	600	50W	50	85°	N.A.	92	Yes	35,000	120V	No	✓
DL 4" 11W	11DL4G3DIM/827	40697	2700K	620	50W	56	85°	N.A.	82	Yes	35,000	120V	No	✓

* GU24 connector available

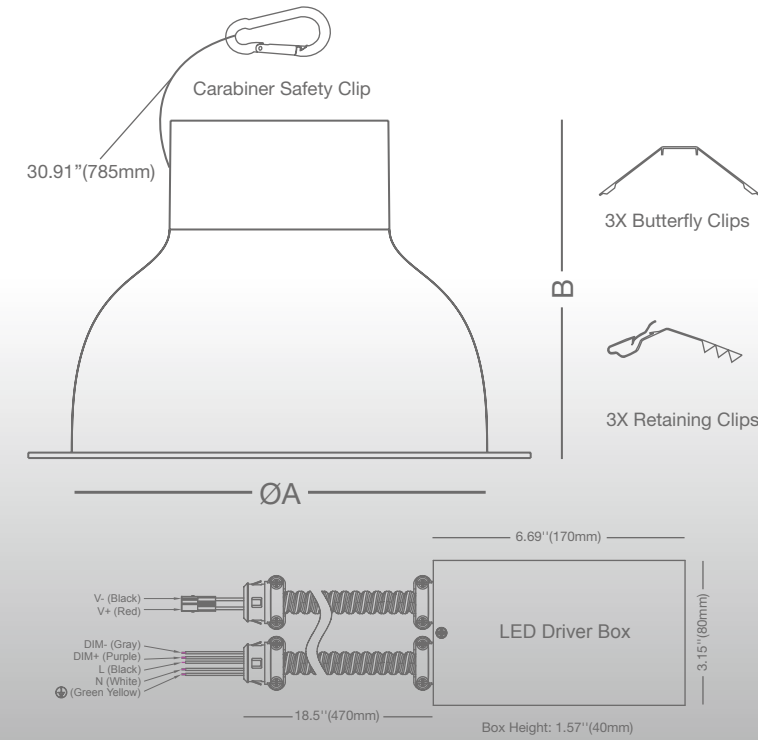

Dimensions		
Model No.:	A	B
48CDL9.5G4DIM/xxx/277V	9.25" (235mm)	6.50" (165mm)
32CDL8G4DIM/xxx/277V	7.80" (197mm)	5.90" (150mm)
22CDL6G4DIM/xxx/277V	6.02" (153mm)	5.39" (137mm)



- Fits existing architectural and commercial housing
- 0-10V dimming – Compatible with 120-277V circuits
- Easy installation – Quick connector and pre-wired conduit
- Superior savings and performance over CFL

SPECIFICATIONS

Model	Product	CCT	Lumens (lm)	Equiv.	LPW	Beam Angle	CBCP (cd)	CRI (typ.)	Dim	Life (hrs)	Voltage	Encl.		
	48CDL9.5G4DIM/830/277V NEW!	97706	3000K	3200	2 X 42W	67	90°	N.A.	80	Yes	40,000	120-277V	No	✓
	48CDL9.5G4DIM/835/277V	97707	3500K	3400	2 X 42W	71	90°	N.A.	80	Yes	40,000	120-277V	No	✓
	48CDL9.5G4DIM/840/277V	97708	4000K	3600	2 X 42W	75	90°	N.A.	80	Yes	40,000	120-277V	No	✓
	32CDL8G4DIM/830/277V NEW!	97696	3000K	2150	2 X 26W	67	90°	N.A.	80	Yes	40,000	120-277V	No	✓
	32CDL8G4DIM/835/277V	97697	3500K	2300	2 X 26W	72	90°	N.A.	80	Yes	40,000	120-277V	No	✓
	32CDL8G4DIM/840/277V	97698	4000K	2450	2 X 26W	77	90°	N.A.	80	Yes	40,000	120-277V	No	✓
	22CDL6G4DIM/830/277V NEW!	97686	3000K	1600	2 X 18W	73	90°	N.A.	80	Yes	40,000	120-277V	No	✓
	22CDL6G4DIM/835/277V	97687	3500K	1650	2 X 18W	75	90°	N.A.	80	Yes	40,000	120-277V	No	✓
	22CDL6G4DIM/840/277V	97688	4000K	1700	2 X 18W	77	90°	N.A.	80	Yes	40,000	120-277V	No	✓

INSTALLATION GUIDE

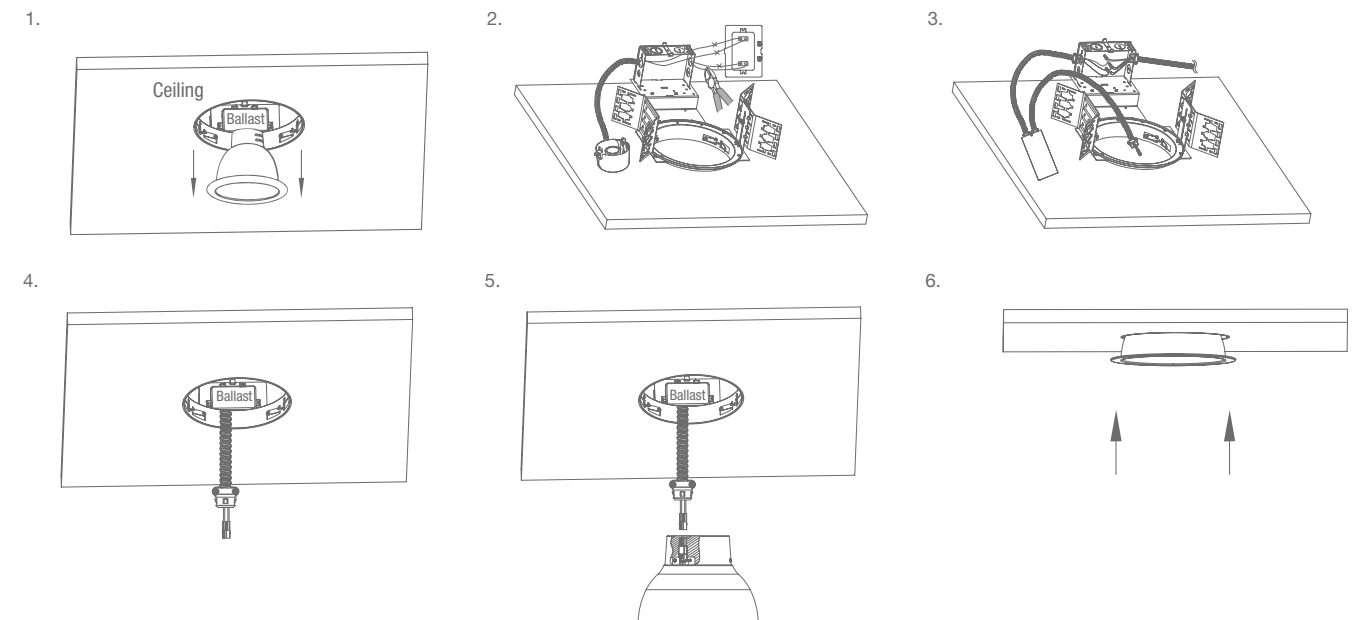

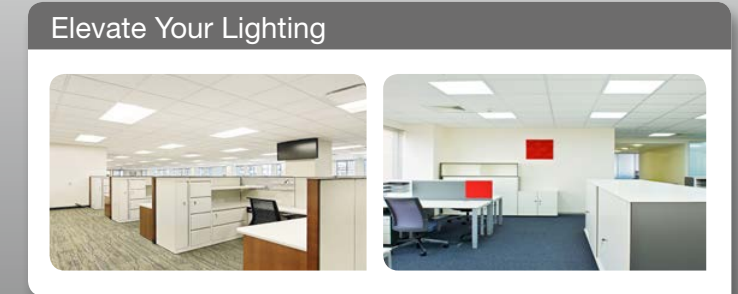
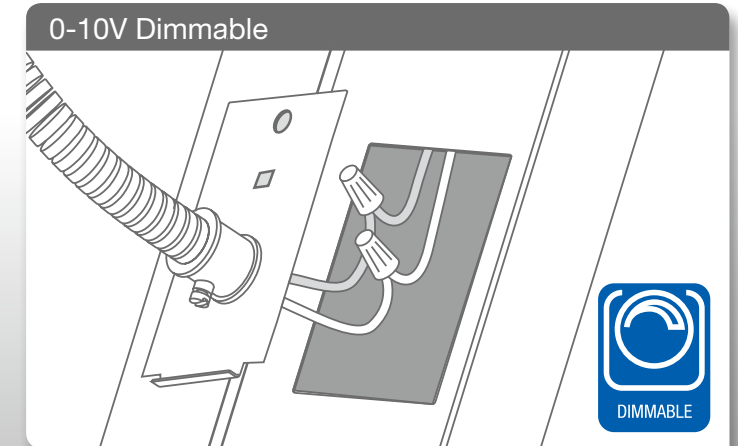
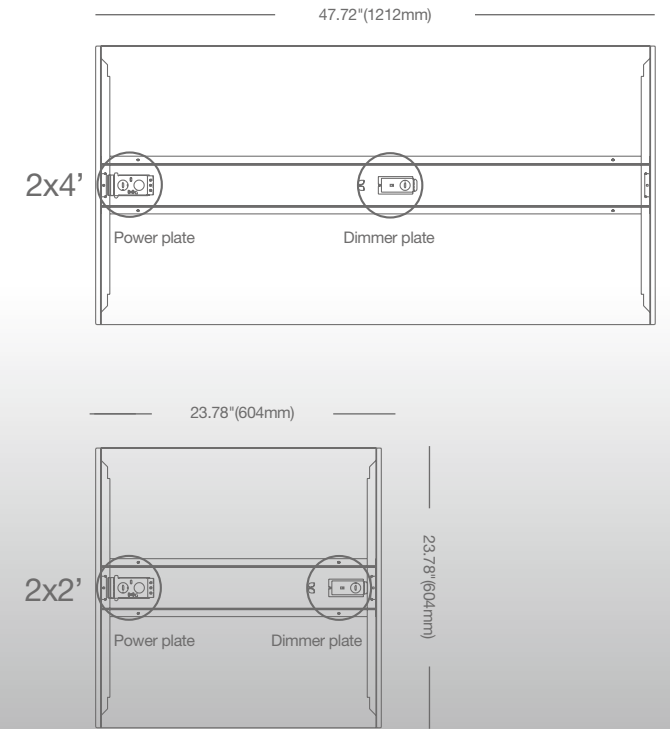

- Easy installation for new construction or retrofit
- Exceptional efficacy meets DLC Premium requirements
- 0-10V dimming – Compatible with 120-277V circuits
- High performance lighting distribution and low glare lens

SPECIFICATIONS*

Model	Product	CCT	Lumens (lm)	LPW	Beam Angle	CBCP (cd)	CRI (typ.)	Dim	Life (hrs)	Voltage	DLC	
TROFFER 2X4' 40W	40TROF24DIM/835/277V	97792	3500K	4280	107	120°	N.A.	80	Yes	50,000	120-277V	Jan.
	40TROF24DIM/840/277V	97793	4000K	4400	110	120°	N.A.	80	Yes	50,000	120-277V	Jan.
TROFFER 2X2' 32W	32TROF22DIM/835/277V	97788	3500K	3520	110	120°	N.A.	80	Yes	50,000	120-277V	Jan.
	32TROF22DIM/840/277V	97789	4000K	3520	110	120°	N.A.	80	Yes	50,000	120-277V	Jan.

* Specification data is preliminary and may be subject to change

INSTALLATION GUIDE

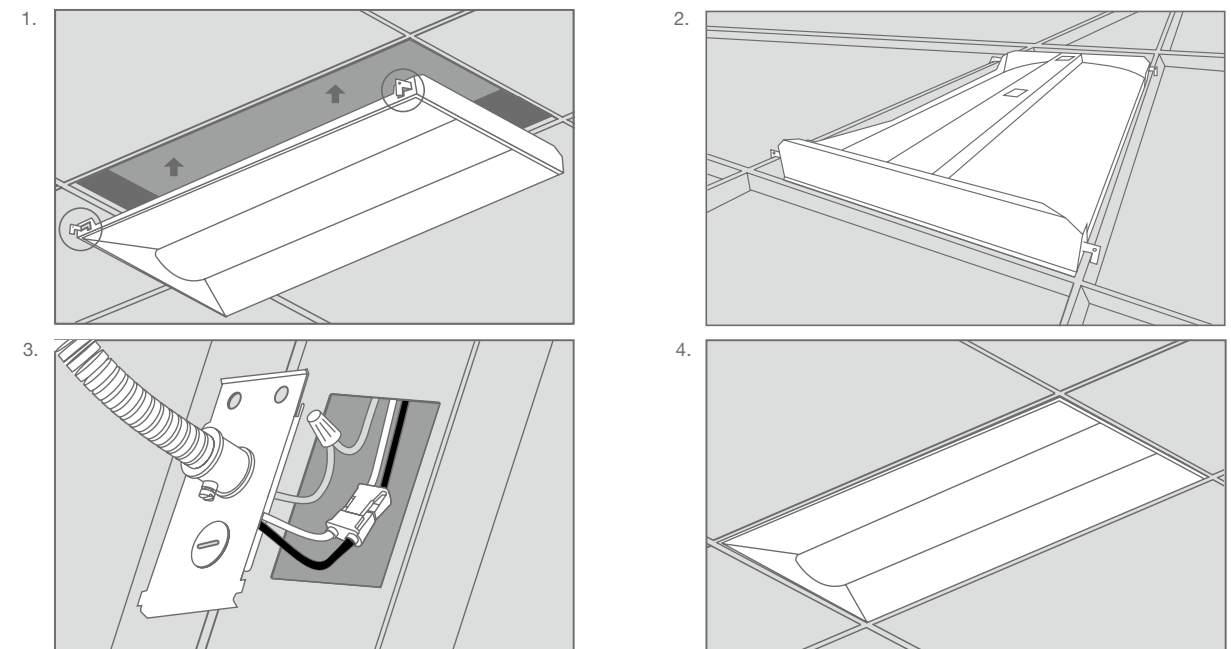

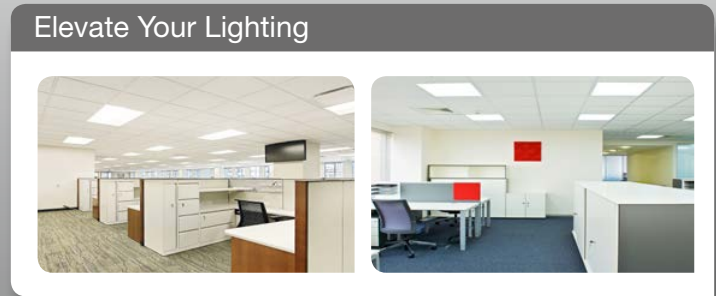
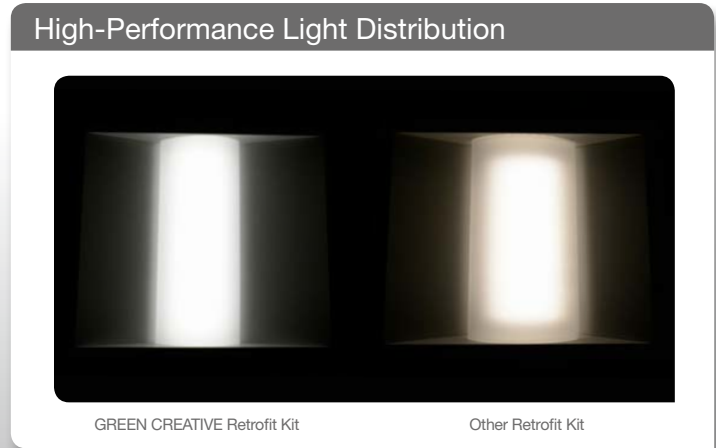
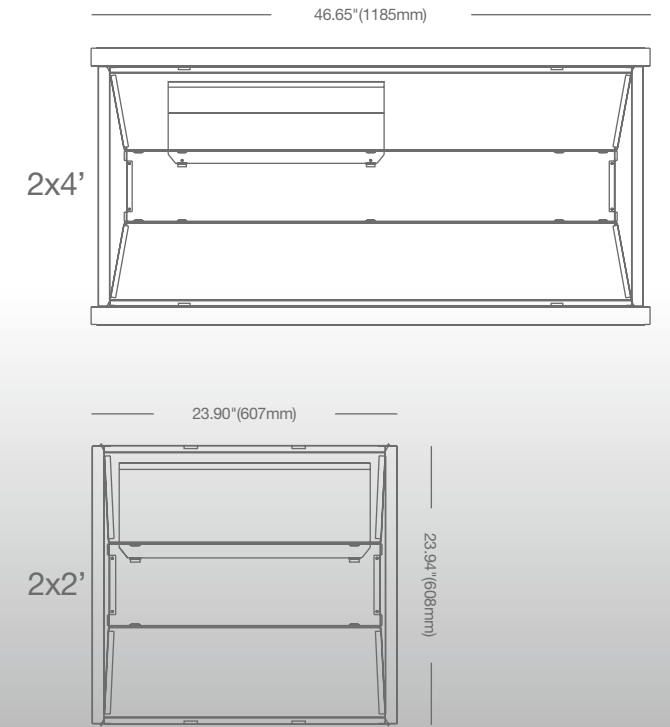

- ⌚ Easy tool-less installation – Installs in 3-5 minutes
- ⌚ Door retrofit kit upgrades troffers and louvers
- ⌚ Exceptional efficacy meets DLC Premium requirements
- ⌚ 0-10V dimming – Compatible with 120-277V circuits

SPECIFICATIONS*

Model	Product	CCT	Lumens (lm)	LPW	Beam Angle	CBCP (cd)	CRI (typ.)	Dim	Life (hrs)	Voltage	DLC	
TROFFER RETROFIT KIT 2X4' 36W	NEW! 36TROFKIT24DIM/830/277V	97799	3000K	3710	103	120°	N.A.	80	Yes	50,000	120-277V	Jan.
	36TROFKIT24DIM/835/277V	97800	3500K	3960	110	120°	N.A.	80	Yes	50,000	120-277V	Jan.
	36TROFKIT24DIM/840/277V	97801	4000K	4150	115	120°	N.A.	80	Yes	50,000	120-277V	Jan.
TROFFER RETROFIT KIT 2X2' 30W	NEW! 30TROFKIT22DIM/830/277V	97795	3000K	3090	103	120°	N.A.	80	Yes	50,000	120-277V	Jan.
	30TROFKIT22DIM/835/277V	97796	3500K	3300	110	120°	N.A.	80	Yes	50,000	120-277V	Jan.
	30TROFKIT22DIM/840/277V	97797	4000K	3300	110	120°	N.A.	80	Yes	50,000	120-277V	Jan.

INSTALLATION GUIDE

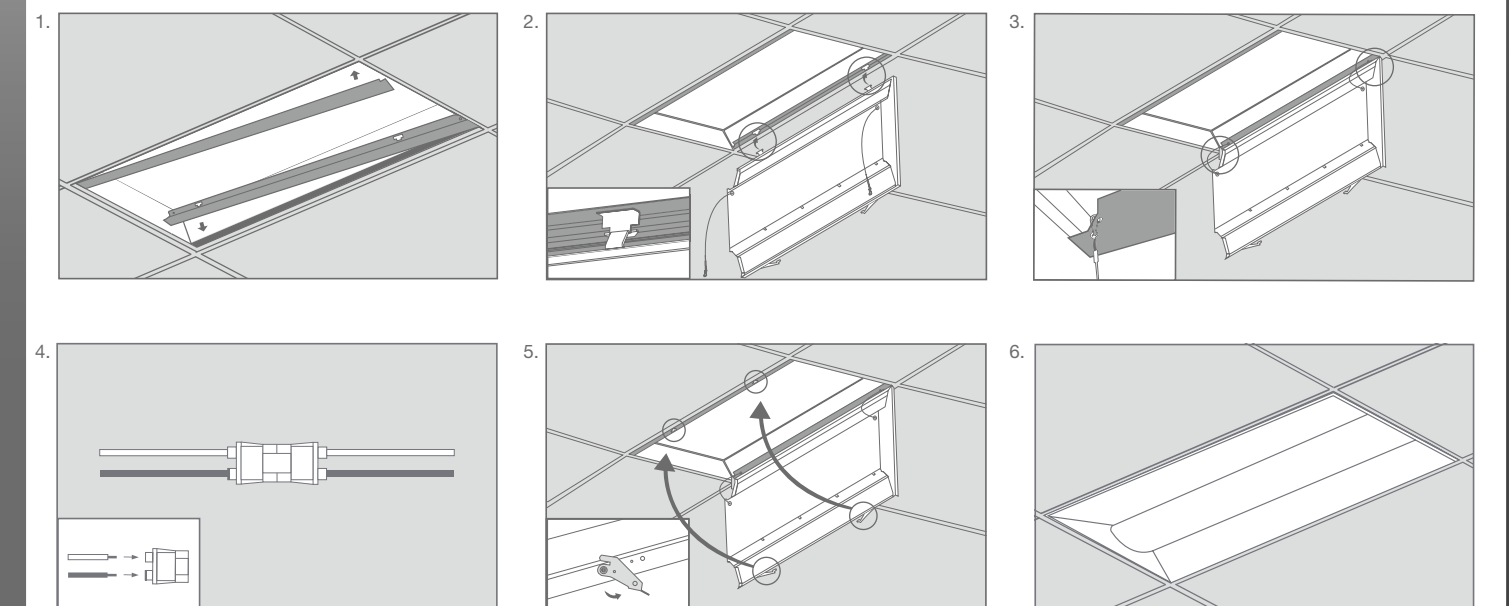

* Specification data is preliminary and may be subject to change



Compatible with Electronic Ballasts - Dimmable

BYPass Installation - Shatterproof Design

120-277V UNIVERSAL

UL1598C classification ensures fixture maintains original UL compliance

Extra Wide Beam Design - End-to-End Lighting

Extra Wide Beam Design - End-to-End Lighting

- Easy to install – Plug and Play Direct
- Instant Start & Programmed Start ballast compatible
- Suitable for use in totally enclosed fixtures
- Dimmable

- Built-in universal voltage driver – Bypass installation
- Wide beam design 310° light emitting area
- Suitable for use in totally enclosed fixtures
- Shatterproof design – meets NSF requirements

SPECIFICATIONS																
	Model	Product	CCT	Lumens (lm)	Equiv.	LPW	Beam Angle	CBCP (cd)	CRI (typ.)	Dim	Life (hrs)	Voltage	Encl.	DLC LISTED		
	15T8/4F/840/DIR NEW!	97833	4000K	2050	32W	137	180°	N.A.	80	Yes	50,000	120-277V	Yes	✓		
	15T8/4F/850/DIR	97834	5000K	2050	32W	137	180°	N.A.	80	Yes	50,000	120-277V	Yes	✓		
	12T8/4F/830/DIR NEW!	97737	3000K	1600	32W	133	180°	N.A.	80	Yes	50,000	120-277V	Yes	✓		
	12T8/4F/835/DIR	97738	3500K	1600	32W	133	180°	N.A.	80	Yes	50,000	120-277V	Yes	✓		
	12T8/4F/840/DIR	97739	4000K	1650	32W	138	180°	N.A.	80	Yes	50,000	120-277V	Yes	✓		
	12T8/4F/850/DIR	97740	5000K	1650	32W	138	180°	N.A.	80	Yes	50,000	120-277V	Yes	✓		
	8T8/2F/830/DIR NEW!	97741	3000K	1050	17W	131	180°	N.A.	80	Yes	50,000	120-277V	Yes	✓		
	8T8/2F/835/DIR	97742	3500K	1050	17W	131	180°	N.A.	80	Yes	50,000	120-277V	Yes	✓		
	8T8/2F/840/DIR	97743	4000K	1100	17W	138	180°	N.A.	80	Yes	50,000	120-277V	Yes	✓		
	10T8G4/2F/850/DIR	40803	5000K	1100	17W	110	140°	N.A.	80	No	50,000	120-277V	Yes	N.A.		
	16T8U6G4/830/DIR	40707	3000K	1650	32W	103	160°	N.A.	80	No	50,000	120-277V	Yes	N.A.		
	16T8U6G4/840/DIR	40848	4000K	1800	32W	113	160°	N.A.	80	No	50,000	120-277V	Yes	N.A.		
	16T8U6G4/850/DIR	40849	5000K	1800	32W	113	160°	N.A.	80	No	50,000	120-277V	Yes	N.A.		

* U-BENT and 10T8G4 DIR are non-dimmable and only compatible with Instant Start ballasts
 ** T8 DIR lamps are not shatterproof

SPECIFICATIONS																
	Model	Product	CCT	Lumens (lm)	Equiv.	LPW	Beam Angle	CBCP (cd)	CRI (typ.)	Dim	Life (hrs)	Voltage	Encl.	DLC LISTED		
	17.5T8/4F/840/BYP NEW!	97829	4000K	2000	32W	114	160°	N.A.	80	No	50,000	120-277V	Yes	✓		
	17.5T8/4F/850/BYP	97830	5000K	2000	32W	114	160°	N.A.	80	No	50,000	120-277V	Yes	✓		
	14.5T8/4F/830/BYP NEW!	97720	3000K	1600	32W	110	160°	N.A.	80	No	50,000	120-277V	Yes	✓		
	14.5T8/4F/835/BYP	97721	3500K	1650	32W	114	160°	N.A.	80	No	50,000	120-277V	Yes	✓		
	14.5T8/4F/840/BYP	97722	4000K	1700	32W	117	160°	N.A.	80	No	50,000	120-277V	Yes	✓		
	14.5T8/4F/850/BYP	97723	5000K	1700	32W	117	160°	N.A.	80	No	50,000	120-277V	Yes	✓		
	15T8G4/4F/850/BYP	40783	5000K	1800	32W	120	180°	N.A.	80	No	50,000	120-277V	Yes	✓		
	8.5T8/2F/830/BYP NEW!	97724	3000K	900	17W	106	160°	N.A.	80	No	50,000	120-277V	Yes	✓		
	8.5T8/2F/835/BYP	97725	3500K	950	17W	112	160°	N.A.	80	No	50,000	120-277V	Yes	✓		
	8.5T8/2F/840/BYP	97726	4000K	1000	17W	118	160°	N.A.	80	No	50,000	120-277V	Yes	✓		
	9T8G4/2F/850/BYP	40789	5000K	1000	17W	111	180°	N.A.	80	No	50,000	120-277V	Yes	✓		

* 15T8G4 BYP and 9T8G4 BYP lamps are not shatterproof and do not meet NSF requirements



Support Clip Included

Extra Wide Beam Design - Compact Driver Technology



Compatible with Electronic Ballasts - Dimmable



- Easy to install – Plug & Play Direct
- Instant Start & Programmed Start ballast compatible
- Suitable for use in totally enclosed fixtures
- 0-10V dimming

SPECIFICATIONS*

Model	Product	CCT	Lumens (lm)	Equiv.	LPW	Beam Angle	CBCP (cd)	CRI (typ.)	Dim	Life (hrs)	Voltage	Encl.	
PLL 17W DIR	NEW! 17PLL/830/DIR	97745	3000K	2000	40W	118	120°	N.A.	80	Yes	50,000	120-277V	Yes
	17PLL/835/DIR	97746	3500K	2050	40W	121	120°	N.A.	80	Yes	50,000	120-277V	Yes
	17PLL/840/DIR	97747	4000K	2100	40W	124	120°	N.A.	80	Yes	50,000	120-277V	Yes
PLL 14.5W DIR	NEW! 14.5PLL/835/DIR	97750	3500K	1550	36W	107	120°	N.A.	80	Yes	50,000	120-277V	Yes

* Specification data is preliminary and may be subject to change

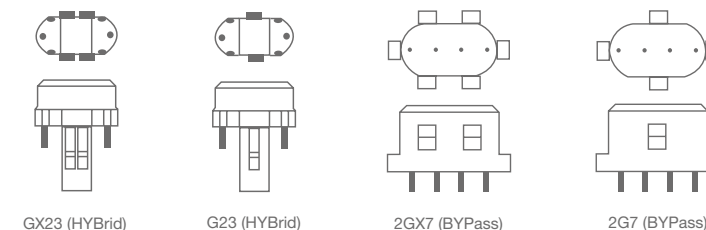

Extra Wide Beam Design - 180° Rotatable Base



Compact Form Factor Fits All Applications



- HYBrid installation – DIRect or BYPass
- BYPass installation – Requires bypassing the ballast
- Suitable for use in totally enclosed fixtures
- 180° rotatable base

SPECIFICATIONS*

Model	Product	CCT	Lumens (lm)	Equiv.	LPW	Beam Angle	CBCP (cd)	CRI (typ.)	Dim	Life (hrs)	Voltage	Encl.	
PLS 5.5W HYB GX23	NEW! 5.5PLS/827/HYB/GX23	57820	2700K	450	13W	82	120°	N.A.	80	No	40,000	120-277V	Yes
	5.5PLS/830/HYB/GX23	57821	3000K	500	13W	91	120°	N.A.	80	No	40,000	120-277V	Yes
	5.5PLS/835/HYB/GX23	57822	3500K	500	13W	91	120°	N.A.	80	No	40,000	120-277V	Yes
	5.5PLS/840/HYB/GX23	57823	4000K	520	13W	95	120°	N.A.	80	No	40,000	120-277V	Yes
PLS 3.5W HYB G23	NEW! 3.5PLS/835/HYB/G23	57814	3500K	300	9W	86	120°	N.A.	80	No	40,000	120-277V	Yes
PLS 5.5W BYP 2GX7	NEW! 5.5PLS/835/BYP/2GX7	57826	3500K	500	13W	91	120°	N.A.	80	No	40,000	120-277V	Yes
PLS 3.5W BYP 2G7	NEW! 3.5PLS/835/BYP/2G7	57818	3500K	300	9W	86	120°	N.A.	80	No	40,000	120-277V	Yes

* Specification data is preliminary and may be subject to change

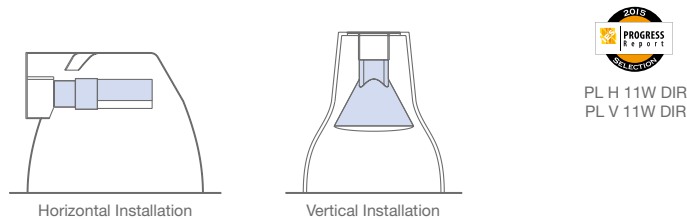

Patent Pending Design Patent Pending Design

High Performance - Ballast Smart Control		
Ballast Type	Lumens	Bare Lamp
13W	720	8W
18W	850	9.5W
26W	1000	11W



- Easy to install – Plug & Play Direct
- For use with 13W, 18W, 26W, 32W & 42W electronic ballasts
- Ballast smart control technology
- Compatible with G24q/GX24q installations

SPECIFICATIONS

Model	Product	CCT	Lumens (lm)	Equiv.	LPW	Beam Angle	CBCP (cd)	CRI (typ.)	Dim	Life (hrs)	Voltage	Encl.	
	11PLHG4/827/DIR NEW!	40817	2700K	850	26W	77	110°	N.A.	80	No	40,000	120-277V	No
	11PLHG4/830/DIR	40818	3000K	920	26W	84	110°	N.A.	80	No	40,000	120-277V	No
	11PLHG4/835/DIR	40819	3500K	950	26W	86	110°	N.A.	80	No	40,000	120-277V	No
	11PLHG4/840/DIR	40820	4000K	1000	26W	91	110°	N.A.	80	No	40,000	120-277V	No
	11PLHG4/850/DIR	40821	5000K	1000	26W	91	110°	N.A.	80	No	40,000	120-277V	No
	11PLHG4/930/DIR NEW!	40823	3000K	800	26W	73	110°	N.A.	90	No	40,000	120-277V	No
	11PLVG4/827/DIR NEW!	97669	2700K	875	26W	80	110°	N.A.	80	No	40,000	120-277V	No
	11PLVG4/830/DIR	97670	3000K	875	26W	80	110°	N.A.	80	No	40,000	120-277V	No
	11PLVG4/835/DIR	97671	3500K	900	26W	82	110°	N.A.	80	No	40,000	120-277V	No
	11PLVG4/840/DIR	97672	4000K	920	26W	84	110°	N.A.	80	No	40,000	120-277V	No
	11PLVG4/850/DIR	97673	5000K	940	26W	85	110°	N.A.	80	No	40,000	120-277V	No
	11PLVG4/930/DIR NEW!	97675	3000K	730	26W	66	110°	N.A.	90	No	40,000	120-277V	No

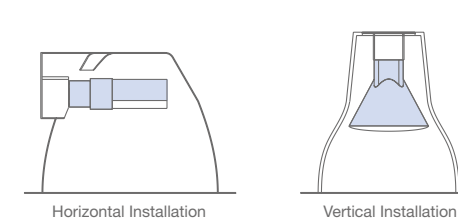

Patent Pending Design Patent Pending Design

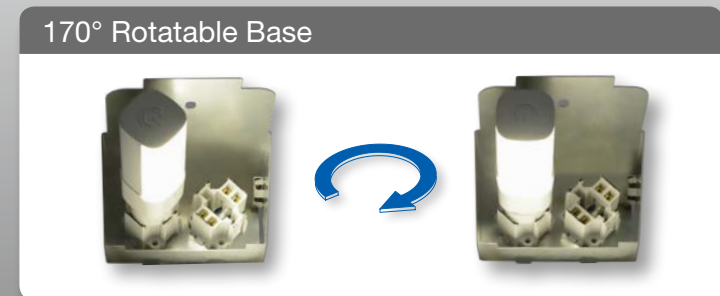
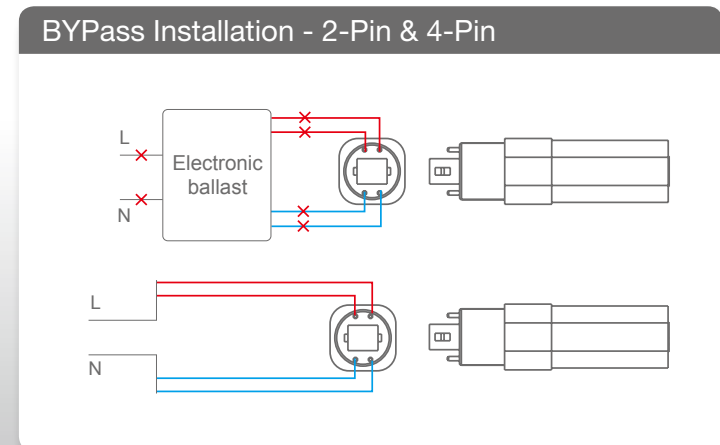

- Built-in universal voltage driver – Bypass installation
- Compatible with G24q/GX24q & G24d/GX24d installations
- High-quality diffuser for maximum light distribution
- Lasts 4 times longer than CFL

SPECIFICATIONS

Model	Product	CCT	Lumens (lm)	Equiv.	LPW	Beam Angle	CBCP (cd)	CRI (typ.)	Dim	Life (hrs)	Voltage	Encl.	
	11PLHG4/835/BYP NEW!	40816	3500K	950	26W	86	110°	N.A.	80	No	40,000	120-277V	No
	11PLHG4/840/BYP	40826	4000K	1000	26W	91	110°	N.A.	80	No	40,000	120-277V	No
	11PLHG4/850/BYP	40827	5000K	1000	26W	91	110°	N.A.	80	No	40,000	120-277V	No
	11PLVG4/835/BYP NEW!	97681	3500K	900	26W	82	110°	N.A.	80	No	40,000	120-277V	No
	11PLVG4/840/BYP	97682	4000K	920	26W	84	110°	N.A.	80	No	40,000	120-277V	No



Designed for Track & Downlighting Applications

HID Replacement

**250W Hal.
39W CMH**
120-277V

- Universal Voltage 120-277V
- 10,000+ candela replaces 250W Hal. & 39W CMH
- Powerful light output 1775 lumens
- Exceptional efficacy 93 LPW in Warm White CCT

SPECIFICATIONS

Model	Product	CCT	Lumens (lm)	Equiv.	LPW	Beam Angle	CBCP (cd)	CRI (typ.)	Dim	Life (hrs)	Voltage	Encl.	ENERGY STAR	
	NEW!													
PAR38 19W HO 277V	19PAR38HO/827NF25/277V	97769	2700K	1725	250W	91	25°	10,000	80	No	40,000	120-277V	No	✓
		97772	3000K	1775	250W	93	25°	10,200	80	No	40,000	120-277V	No	✓
		97778	4000K	1850	250W	97	25°	10,400	80	No	40,000	120-277V	No	✓



Designed for Bollard & Post Top Applications

HID Replacement

**50-70W
HID**
120-277V



- Universal Voltage 120-277V
- Meets ENERGY STAR® A-lamp requirements
- Optional lamp extender available for use in larger fixtures
- Suitable for use in totally enclosed fixtures

SPECIFICATIONS

Model	Product	CCT	Lumens (lm)	Equiv.	LPW	Beam Angle	CBCP (cd)	CRI (typ.)	Dim	Life (hrs)	Voltage	Encl.	ENERGY STAR	
	NEW!													
A21 18.5W HO 277V	18.5A21/830/277V	97734	3000K	2000	50-70W HID	108	330°	N.A.	80	No	40,000	120-277V	Yes	✓
		97736	5000K	2050	50-70W HID	111	330°	N.A.	80	No	40,000	120-277V	Yes	✓



LIGHTING for tomorrow

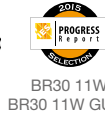

T24 2013



BR30 11W GU24

BR30 11W BR30 11W GU24

BR30 8W

BR30 11W GU24

BR30 11W BR30 11W GU24

BR30 11W BR30 11W GU24



Uses 35% Less Material than Previous Generation



- Revolutionary CLOUD design
- 60% lighter due to environmentally friendly construction
- BR30 high CRI & GU24 versions available
- Suitable for use in totally enclosed fixtures

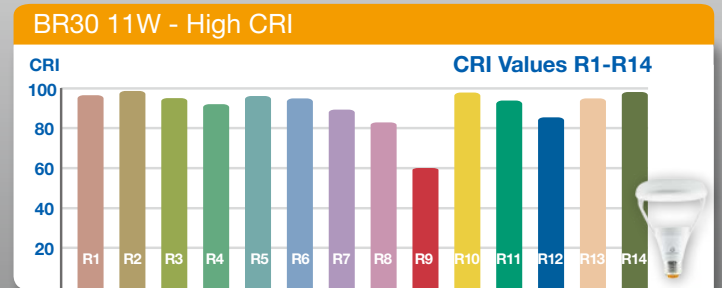

SPECIFICATIONS

Model	Product	CCT	Lumens (lm)	Equiv.	LPW	Beam Angle	CBCP (cd)	CRI (typ.)	Dim	Life (hrs)	Voltage	Encl.	Energy Star	
BR40 14W	14BR40G4DIM/827	40636	2700K	1065	85W	76	110°	N.A.	82	Yes	25,000	120V	Yes	✓
	14BR40G4DIM/830	40637	3000K	1100	85W	79	110°	N.A.	82	Yes	25,000	120V	Yes	✓
BR40 9W	9BR40G4DIM/824	40626	2400K	650	65W	72	110°	N.A.	80	Yes	25,000	120V	Yes	N.A.
	9BR40G4DIM/827	40627	2700K	700	65W	78	110°	N.A.	82	Yes	25,000	120V	Yes	✓
BR30 8W	8BR30G4DIM/824	40770	2400K	585	65W	73	110°	N.A.	80	Yes	25,000	120V	Yes	N.A.
	8BR30G4DIM/827	40771	2700K	650	65W	81	110°	N.A.	82	Yes	25,000	120V	Yes	✓
	8BR30G4DIM/830	40772	3000K	685	65W	86	110°	N.A.	82	Yes	25,000	120V	Yes	✓
	8BR30G4DIM/840	40773	4000K	710	65W	89	110°	N.A.	82	Yes	25,000	120V	Yes	✓

SPECIFICATIONS

Model	Product	CCT	Lumens (lm)	Equiv.	LPW	Beam Angle	CBCP (cd)	CRI (typ.)	Dim	Life (hrs)	Voltage	Encl.	Energy Star	
BR30 7.5W	7.5BR30G4/827	40774	2700K	650	65W	87	110°	N.A.	82	No	25,000	120V	Yes	✓
BR30 11W	11BR30G4DIM/927	40644	2700K	750	65W	68	110°	N.A.	92	Yes	25,000	120V	Yes	✓
BR30 11W GU24	11BR30G4DIM/927/GU24	40646	2700K	750	65W	68	110°	N.A.	92	Yes	25,000	120V	Yes	✓
R20 6.5W	6.5R20G4DIM/824	40611	2400K	450	45W	69	110°	N.A.	80	Yes	25,000	120V	Yes	N.A.
	6.5R20G4DIM/827	40612	2700K	500	45W	77	110°	N.A.	82	Yes	25,000	120V	Yes	✓

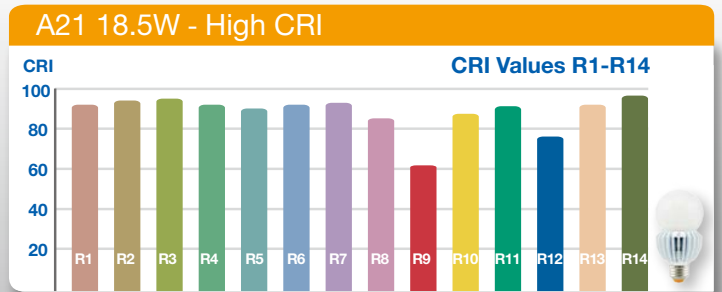

- A21 3-WAY with 3 defined lumen outputs
- GU24 base 100W & 60W replacements
- Enclosed fixture rated 100W & 75W replacements
- High CRI 100W & 75W replacements



SPECIFICATIONS

Model	Product	CCT	Lumens (lm)	Equiv.	LPW	Beam Angle	CBCP (cd)	CRI (typ.)	Dim	Life (hrs)	Voltage	Encl.	Energy Star
A21 17W	17A21G4DIM/827	16179	2700K	1600	100W	94	330°	N.A.	80	Yes	25,000	120V	Yes ✓
	17A21G4DIM/830	16180	3000K	1650	100W	97	330°	N.A.	80	Yes	25,000	120V	Yes ✓
	17A21G4DIM/840	16181	4000K	1700	100W	100	330°	N.A.	80	Yes	25,000	120V	Yes ✓
A21 17W GU24	17A21DIM/827/GU24	16332	2700K	1600	100W	94	330°	N.A.	80	Yes	25,000	120V	Yes ✓
A19 12W	12A19G4DIM/827	16175	2700K	1100	75W	92	330°	N.A.	80	Yes	25,000	120V	Yes ✓
	12A19G4DIM/830	16176	3000K	1150	75W	96	330°	N.A.	80	Yes	25,000	120V	Yes ✓
	12A19G4DIM/840	16177	4000K	1180	75W	98	330°	N.A.	80	Yes	25,000	120V	Yes ✓
A19 9W	9A19G4DIM/824	40741	2400K	700	60W	78	300°	N.A.	80	Yes	25,000	120V	No N.A.
	9A19G4DIM/827	40742	2700K	800	60W	89	300°	N.A.	80	Yes	25,000	120V	No ✓
	9A19G4DIM/830	40743	3000K	800	60W	89	300°	N.A.	80	Yes	25,000	120V	No ✓
	9A19G4DIM/840	40744	4000K	850	60W	94	300°	N.A.	80	Yes	25,000	120V	No ✓
A19 9W GU24	9A19DIM/827/GU24	57831	2700K	800	60W	84	300°	N.A.	80	Yes	25,000	120V	No ✓
	9A19DIM/830/GU24	57832	3000K	800	60W	84	300°	N.A.	80	Yes	25,000	120V	No ✓
	9A19DIM/840/GU24	57833	4000K	850	60W	89	300°	N.A.	80	Yes	25,000	120V	No ✓
A19 6.5W	6.5A19G4DIM/827	40732	2700K	470	40W	72	300°	N.A.	80	Yes	25,000	120V	Yes ✓
	6.5A19G4DIM/830	40733	3000K	480	40W	74	300°	N.A.	80	Yes	25,000	120V	Yes ✓



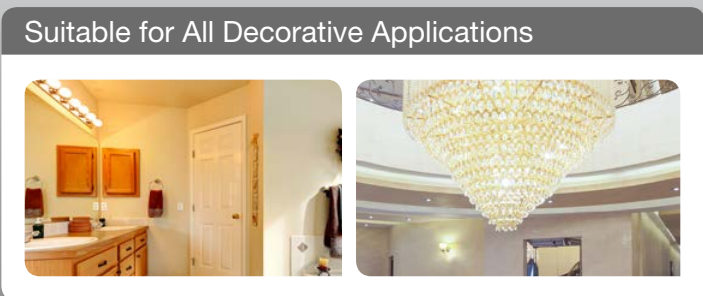
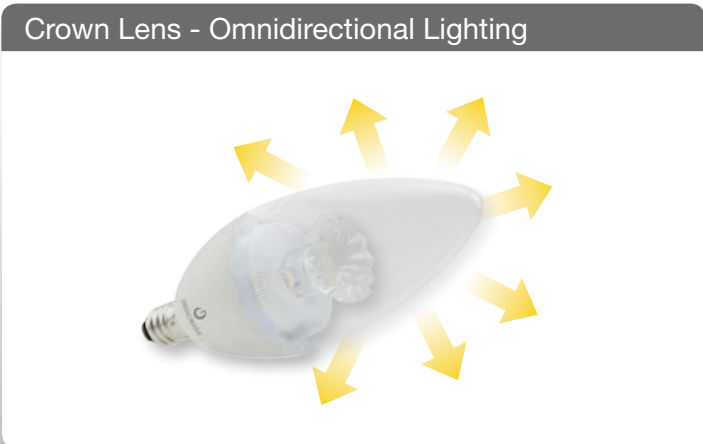

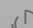
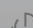
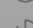

SPECIFICATIONS

Model	Product	CCT	Lumens (lm)	Equiv.	LPW	Beam Angle	CBCP (cd)	CRI (typ.)	Dim	Life (hrs)	Voltage	Encl.	Energy Star
A21 18.5W	18.5A21DIM/927	16329	2700K	1600	100W	86	330°	N.A.	90	Yes	25,000	120V	Yes ✓
A21 3-WAY 5.5/10.5/17W	17A21G4/827/3WAY	16335	2700K	500	40W	91	330°	N.A.	80	No	25,000	120V	No ✓
				1600	100W	94							
A21 15W	15A21DIM/927	16326	2700K	1100	75W	73	330°	N.A.	90	Yes	25,000	120V	Yes ✓
A19 9W 277V	9A19G4/827/277V	40750	2700K	800	60W	89	300°	N.A.	80	No	25,000	120-277V	No ✓
	9A19G4/830/277V	40751	3000K	800	60W	89	300°	N.A.	80	No	25,000	120-277V	No ✓
	9A19G4/840/277V	40752	4000K	850	60W	94	300°	N.A.	80	No	25,000	120-277V	No ✓
A19 9W	9A19G4DIM/927	40746	2700K	800	60W	89	300°	N.A.	92	Yes	25,000	120V	No ✓
A19 11W GU24	11A19G4DIM/927/GU24	40739	2700K	800	60W	73	300°	N.A.	92	Yes	25,000	120V	No ✓



-  60W & 40W incandescent replacements
-  Innovative crown lens creates unique sparkling effect
-  Available in E12 & E26 bases
-  Smooth dimming with existing installations

SPECIFICATIONS

Model	Product	CCT	Lumens (lm)	Equiv.	LPW	Beam Angle	CBCP (cd)	CRI (typ.)	Dim	Life (hrs)	Voltage	Encl.		
 G25 6W	NEW! 6G25DIM/827	97729	2700K	450	40W	75	275°	N.A.	80	Yes	25,000	120V	No	✓
 B11 5.5W E12 & E26	NEW! 5.5B11DIM/827	97823	2700K	500	60W	91	230°	N.A.	80	Yes	25,000	120V	No	✓
	5.5B11DIM/827/E26	97824	2700K	500	60W	91	230°	N.A.	80	Yes	25,000	120V	No	✓
 B11 5W E12	5B11G4DIM/827/FR	40730	2700K	350	40W	70	275°	N.A.	82	Yes	25,000	120V	No	✓
 B11 4.5W E12	NEW! 4.5B11DIM/827	97817	2700K	300	40W	64	230°	N.A.	80	Yes	25,000	120V	No	✓
 B11 4.5W E12 & E26	4.5B11G4DIM/824	40725	2400K	275	40W	61	275°	N.A.	83	Yes	25,000	120V	No	N.A.
	4.5B11G4DIM/827/E26	40728	2700K	315	40W	70	275°	N.A.	80	Yes	25,000	120V	No	✓

Bringing You the Latest in LED Technology





GREEN CREATIVE

220 South Spruce Ave., Suite 203
South San Francisco, CA 94080
Tel / Fax: (866) 774-5433
info@greencreative.com

www.greencreative.com



/ GREENCREATIVELED



/ GClightingLED



/ GREEN CREATIVE



GREENCREATIVE